

Service Information

Mazda Motor Corporation

3-1, Shinchi, Fuchu-cho, Aki-gun
Hiroshima 730-8670, Japan
TEL : 81(82)287-5323
FAX : 81(82)287-5220



Category B	Technical	Ref. No. E002/15A	Page 1 of 1
Coverage <input type="checkbox"/> Distributor only <input checked="" type="checkbox"/> Please inform your dealers		Date Issued January 14, 2015	
Please convey this information to your <input type="checkbox"/> Director <input checked="" type="checkbox"/> General Manager <input checked="" type="checkbox"/> Warranty Dept. <input checked="" type="checkbox"/> Parts Dept. <input checked="" type="checkbox"/> Training Dept. <input checked="" type="checkbox"/> Field Rep.		Date Revised April 9, 2015	
Applicable Model All models with SKYACTIV-Engine (Diesel and Gasoline)		Applicable Countries or Specifications Worldwide	

REVISED

Revision NOTE: To prevent the oil pan from scratching by tool when tightening the drain plug, the hexagon head type drain plug has been changed to one with flange.

Subject: Introduction of Hexagon Head Type Drain Plug for Engine Oil Pan

DESCRIPTION

This Service Information introduces that the existing **hexagon head type** drain plug (**LFE5-10-404**) can be used for the oil pan of SKYACTIV-D&G engines. This drain plug and the originally equipped **hexagon socket head type** drain plug (FS50-21-249) are interchangeable in both ways.

*Either of the following two drain plugs can be used for SKYACTIV-D&G engine oil pan.

**Hexagon socket head type drain plug
(Part No: FS50-21-249)**

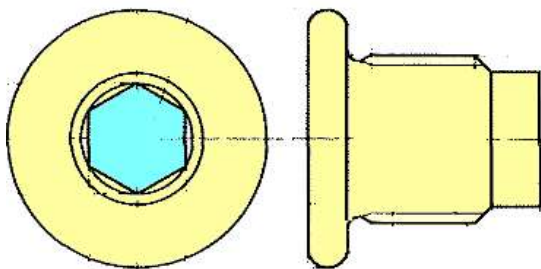

**Hexagon head type drain plug
(Part No.: LFE5-10-404)**

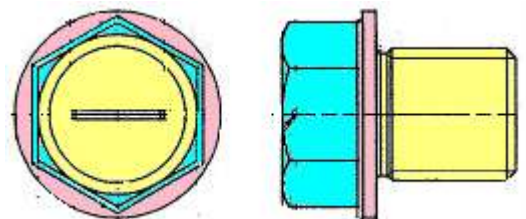

With flange

Tightening Torque (for both drain plugs) is: Refer to WORKSHOP MANUAL.

Ryu Shimizugawa
Manager, Technical Information Gr.
Technical Service Dept.
Mazda Motor Corporation
2E40863123 (MC Internal Use)